



DESCRIPTION: CAT5E, RJ11 (4P4C) MODULAR PLUG, UNSHIELDED, SOLID/STRANDED, FLAT/ROUND CABLE

MODEL NUMBER: 32-5964UL

APPLICATION: MODULAR PLUG

CRIMP TOOL: N/A

IMPEDANCE: N/A

FREQUENCY RANGE: N/A

MATERIAL: HOUSING CLEAR POLYCARBONATE UL94-V0
CONTACT PHOSPHOR BRONZE
SELECTIVE GOLD PLATING

RoHS COMPLIANCE: YES

TECHINCAL DETAIL: N/A

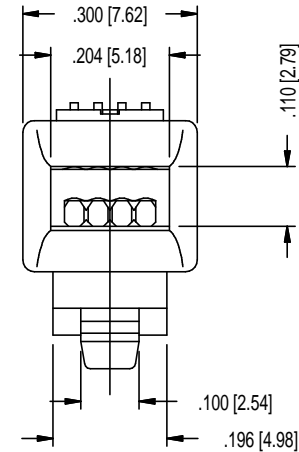
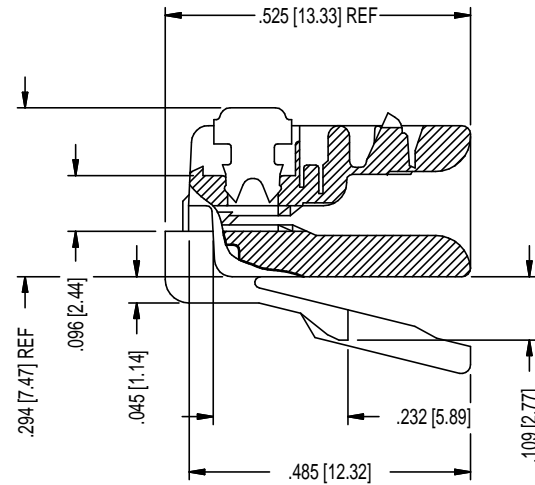
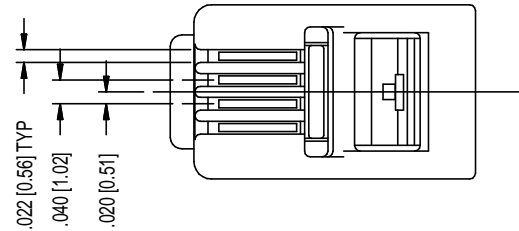
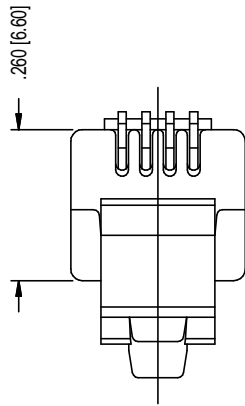

<p>This PROPRIETARY Document is property of Cinch Connectivity Solutions. It is confidential in nature, non-transferable, and issued with the clear understanding that it is not to be traded or copied without permission and is returnable upon demand.</p> <p>INTERPRET DRAWING IN ACCORDANCE WITH ASME Y14.5-2009.</p>		AIM-Cambridge	
	RoHS2 <input checked="" type="checkbox"/> 2011/65/EU	Title: CAT5E, RJ11 (4P4C) Modular Plug, Unshielded, Solid/Stranded, Flat/Round Cable	
	UNLESS OTHERWISE SPECIFIED .XX ±.02 .XXX ±.005 ANGLES ±2°	Model No. 32-5964UL	
	Size A	DO NOT SCALE DRAWING	Date: 2015/12/9